

welcome to

Holmer House Farm

Holmer • Hereford



A modern development of
2 bedroom new homes
for shared ownership sale

welcome to your new home

Holmer House Farm, Holmer

Hereford, HR4 9FL

2 Bedroom Semi-Detached | **Plots 374 & 375**



Kitchen

Contemporary kitchen cupboards
Stainless steel oven,
hob and extractor
Vinyl flooring
Space for washing machine
and fridge/freezer

Bathroom

Three piece white suite
Family bathroom
Complimentary wall tiling
Downstairs WC
Vinyl flooring

General

Located near Hereford City
Range of local amenities
Excellent transport Links
Allocated parking space
10 year build warranty
Turfed rear garden

CGI shown is for Illustrations purposes only.

Holmer House Farm, Holmer

Hereford, HR4 9FL

2 Bedroom Semi-Detached | **Plots 374 & 375**

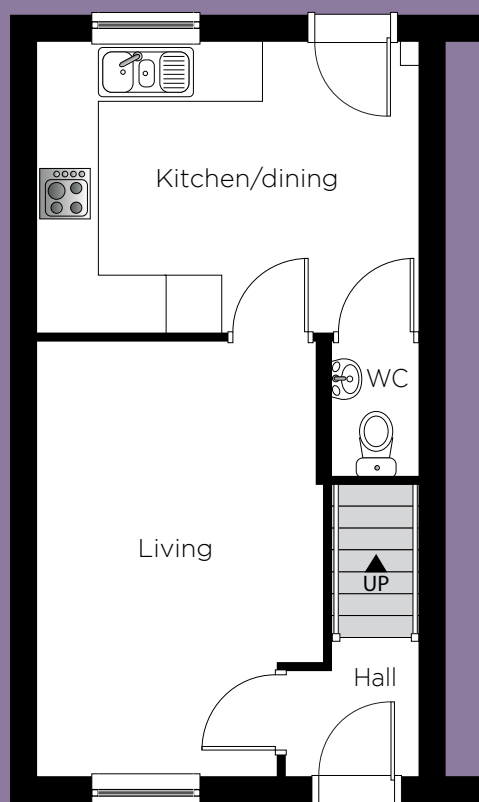

Ground Floor

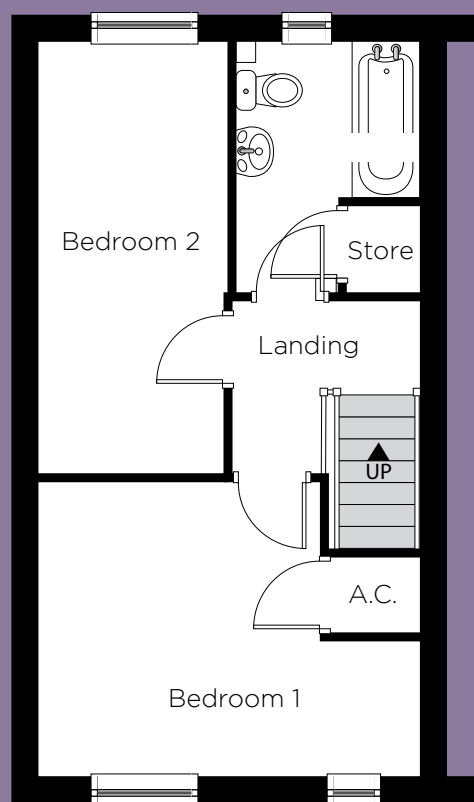

First Floor

Please note:
Some plots will
be the opposite
floor layout to
shown.

Ground Floor

Kitchen/ dining	4.52m 14' 10"	x 3.24m (max) x 10' 7" (max)
Living	4.84m 15' 11"	x 3.16m (max) x 10' 4" (max)

First Floor

Bed 1	4.52m 14' 10"	x 3.28m (max) x 10' 9" (max)
Bed 2	4.80m 15' 9"	x 2.13m (max) x 7' 0" (max)
Bathroom	2.79m 9' 2"	x 2.05m (max) x 6' 9" (max)

Total Floor Area:

73.70m²/793.33 sq.ft

Kitchen layouts are indicative only. Please consult with Platform staff for specific plans, room dimensions and kitchen layouts. The information is for guidance only and is not to be relied on as statements or representations of fact and they do not make or give representation or warrant whatsoever and do not form part of any contract. All room measurements shown in metric first followed by imperial underneath.

Holmer House Farm, Holmer

Hereford, HR4 9FL

Site plan



Development



2 Bedroom Semi-detached
houses Plots 374 & 375



Part of the **platform**
housing group

For further details please contact our sales team on: **0333 200 7304** or email: sales@platformhg.com

Contact Us: www.platformhomeownership.com | facebook.com/PlatformHomeOwnership
 twitter.com/PlatformNewHome | instagram.com/platformhomeownership

Holmer House Farm, Holmer

Hereford, HR4 9FL

House prices for all plots available



Houses available

Plot	House Type	Postal Address	Handover	100% Price	40% Share Value	Monthly Rent	Service Charge
374	2 Bedroom Semi-Detached House	16 Emerald Drive, Holmer, Hereford HR4 9FG.	June 2024	£265,000	£106,000	£364.38	£38.32
375	2 Bedroom Semi-Detached House	18 Emerald Drive, Holmer, Hereford HR4 9FG.	July 2024	£265,000	£106,000	£364.38	£38.32

For further details please contact our sales team on: **0333 200 7304** or email: sales@platformhg.com

Contact Us:  www.platformhomeownership.com |  facebook.com/PlatformHomeOwnership
 twitter.com/PlatformNewHome |  instagram.com/platformhomeownership

For details contact our sales team
on **0333 200 7304**
or email: **sales@platformhg.com**

Contact Us:



www.platformhomeownership.com



facebook.com/PlatformHomeOwnership



twitter.com/PlatformNewHome



instagram.com/platformhomeownership

Scheme administered by Platform Housing Group
1700 Solihull Parkway, Birmingham Business Park, Solihull, B37 7YD.

Part of the **platform**
housing group