



welcome to
**Regency
Gate**

Worcester • Worcestershire



A modern development of
2 & 3 bedroom new homes
for shared ownership sale

welcome to your new home

Regency Gate, Worcester

Worcestershire, WR2

3 Bedroom Semi-Detached House | **Plots 195 & 196**

platform 
home
OWNERSHIP



Kitchen

Contemporary kitchen, with integrated fridge/freezer
Stainless steel oven, hob and extractor
Vinyl flooring

Bathroom

Three piece white suite
Family Bathroom
Complimentary wall tiling
Downstairs WC
Vinyl flooring

General

Located near the City of Worcester
Range of Local amenities
Excellent transport links
Two Allocated Parking Spaces
10 Year Build Warranty
Turfed Rear Garden with Garden Shed

CGI shown is for illustrations purposes only.

Regency Gate, Worcester

Worcestershire, WR2

3 Bedroom Semi-Detached House | **Plots 195 & 196**

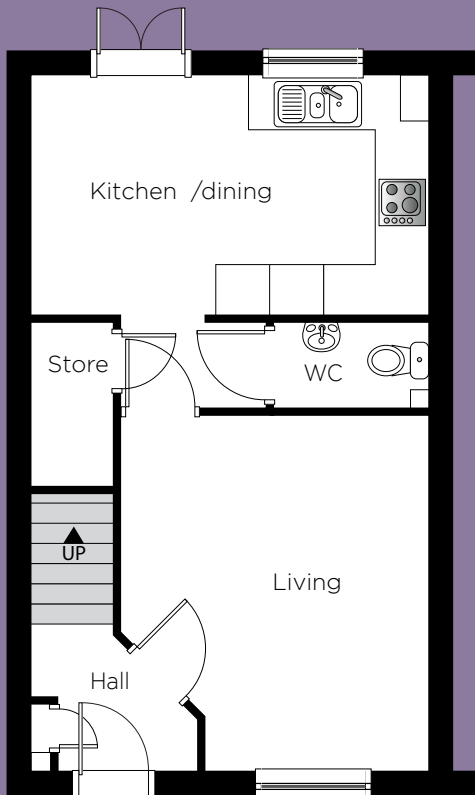

Ground Floor

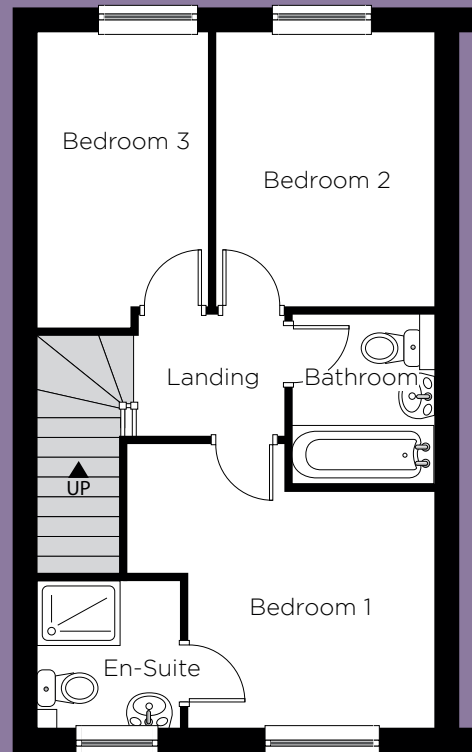

First Floor

Please note:
Some plots will be the opposite floor layout to shown.

Ground Floor

Kitchen/ dining	4.79m 15' 9"	x	2.92m 9' 7"	(max)
Living	4.30m 14' 1"	x	3.69m 12' 1"	(max)

First Floor

Bed 1	3.01m 9' 10"	x	2.87m 9' 5"	(max)
En-Suite	1.80m 5' 11"	x	1.72m 5' 8"	(max)
Bed 2	3.34m 10' 11"	x	2.68m 8' 9"	(max)
Bed 3	3.59m 11' 9"	x	2.05m 6' 9"	(max)
Bathroom	1.80m 5' 11"	x	1.72m 5' 8"	(max)

Total Floor Area:

85.26m²/917.75 sq.ft

Kitchen layouts are indicative only. Please consult with Platform staff for specific plans, room dimensions and kitchen layouts. The information is for guidance only and is not to be relied on as statements or representations of fact and they do not make or give representation or warrant whatsoever and do not form part of any contract. All room measurements shown in metric first followed by imperial underneath.

Regency Gate, Worcester

Worcestershire, WR2

Site plan



Development

 3 Bedroom Semi-Detached houses Plots 195 & 196

Part of the  platform housing group

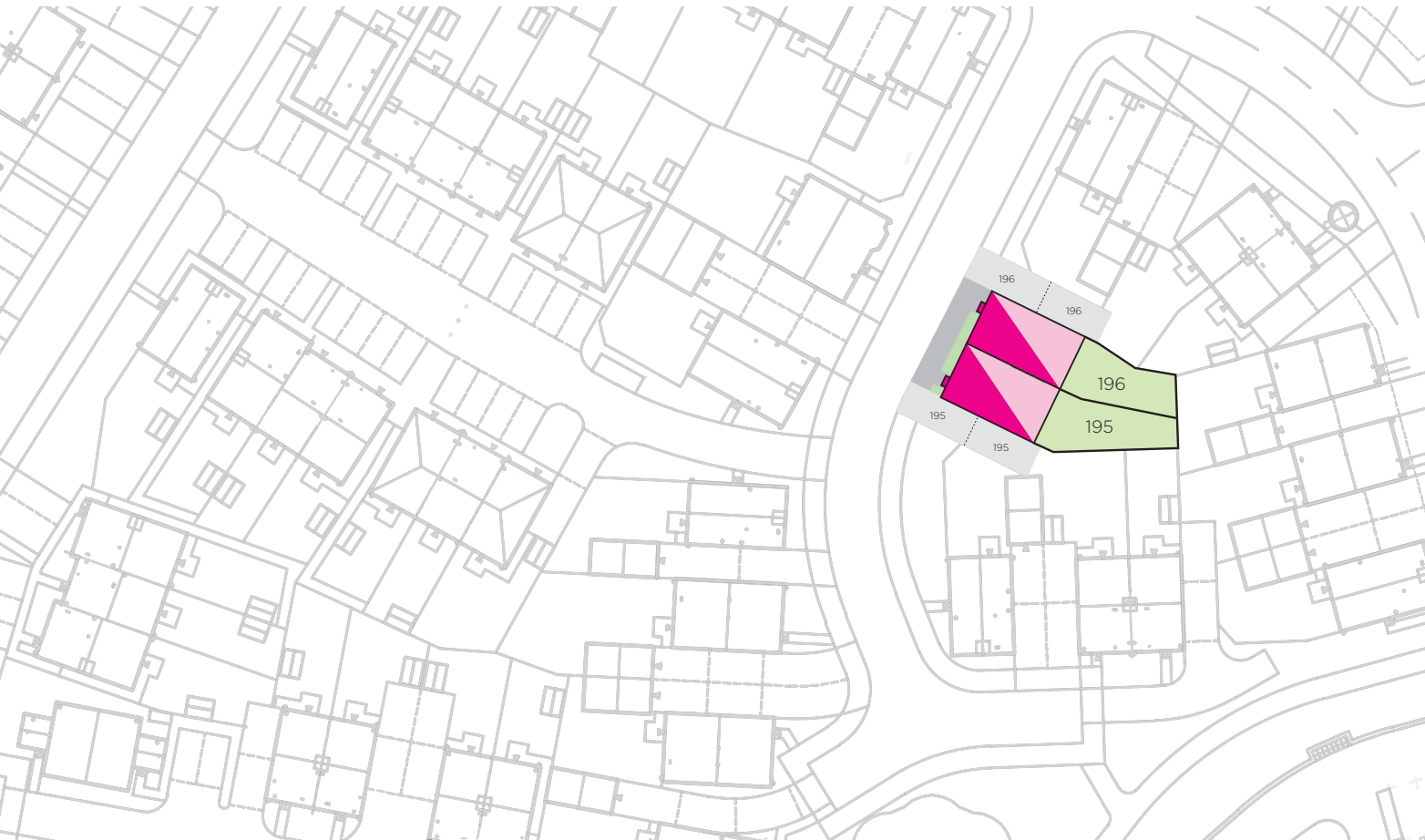

For further details please contact our sales team on: **0333 200 7304** or email: sales@platformhg.com

Contact Us:  www.platformhomeownership.com |  facebook.com/PlatformHomeOwnership
 twitter.com/PlatformNewHome |  instagram.com/platformhomeownership

For details contact our sales team
on **0333 200 7304**
or email: **sales@platformhg.com**

Contact Us:



www.platformhomeownership.com



facebook.com/PlatformHomeOwnership



twitter.com/PlatformNewHome



instagram.com/platformhomeownership

Scheme administered by Platform Housing Group
1700 Solihull Parkway, Birmingham Business Park, Solihull, B37 7YD.

Part of the **platform**
housing group